

ASHFORD COUNTRY SPINNER BOBBIN

Before commencing, please read these instructions completely, identify the parts and note the assembly sequence.

Remove any sharp corners or edges and smooth the surface of the wood with the sand paper provided. We recommend that the wood surfaces be waxed or sealed before assembly. This protects the kiln dried wood from the climatic changes and prevents it getting dirty or stained. The Beech timber has a lovely variety of colour and grain. For a silky smooth matt finish, use the Ashford Finishing Wax Polish to enhance the natural colours and character of this timber.

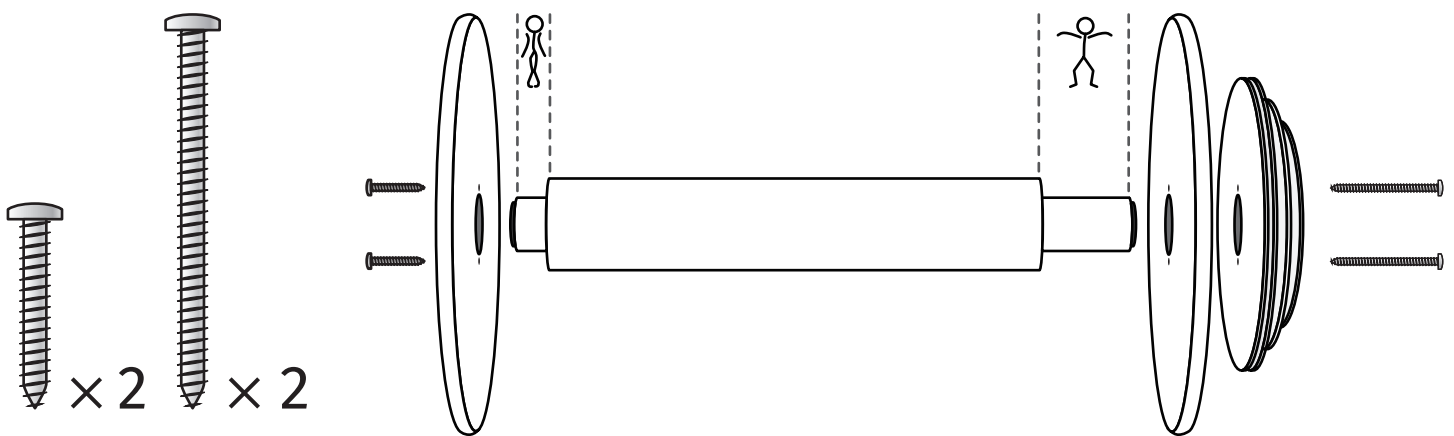

1. Assemble the bobbin by aligning the screw holes in the bobbin end, whorl and long end of the bobbin centre.
2. Then push the bobbin end and whorl onto the bobbin centre keeping the holes aligned and secure with 50mm (2") round head screws.
3. Align the screw holes in the other bobbin end and short end of the bobbin centre.
4. Push the bobbin end onto the bobbin centre keeping the holes aligned and secure with 25mm (1") round head screws.



Hints

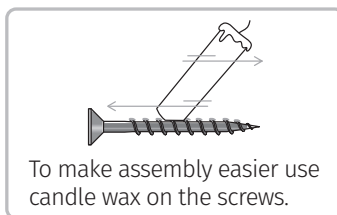
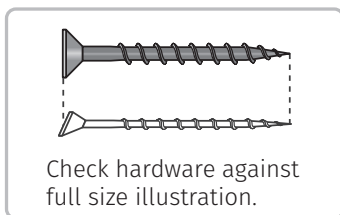

CSB101023

More Information



How-to videos on You Tube
Watch our how-to videos on You Tube.
@AshfordNZ



Blog
For inspirational articles, patterns and projects.
Subscribe for free to the Ashford Blog
www.ashford.co.nz/blog



Facebook
Join us on facebook [ashford.wheels.ooms](https://www.facebook.com/ashford.wheels.ooms)